

Hand Monitor MM1

- Exceptional operational reliability
- Long life and maintenance free



The MM1 is a lightweight and cost-effective manual monitor, designed for use at operating pressures between 5 and 15 bar g.

Fabricated in corrosion resistant gunmetal this monitor is ideally suited to water cooling and non-aspirated foam applications, when fitted with suitable water nozzle. It is also a highly attractive monitor for mounting hydrant elbows.

The single 75mm (3") waterway-design is capable of maximum flows up to 4500 litres/min and built-in flow straighteners provide optimum hydraulic efficiency.

The monitor is capable of full 360° rotation with generous elevational movement covering 85° above and 50° below horizontal. Separate friction locks will maintain the monitor position, once set for prolonged unattended operation.

Smooth movement is provided by a double row of bearings at each rotating joint with precise adjustment controlled by a stainless steel positioning handle.

Recommended for use with the LTN monitor nozzles from Angus Fire. Please refer to our model HM80 if a foam cannon is required.

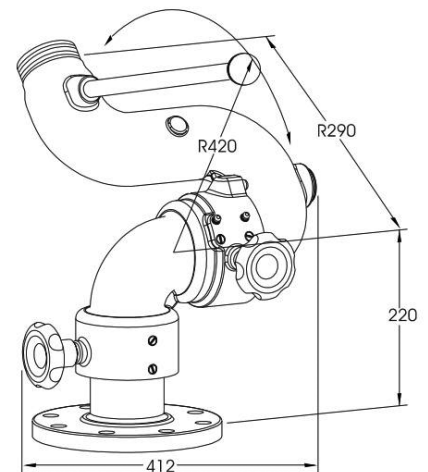

Dimensions in mm.

Specification

Operating pressure	Min: 5 bar g (70psi), Max: 15 bar g (215psi)
Test pressure	22.5 bar g (325psi)
Maximum flow	4,500 litres/min
Inlet flange connection	4" ANSI Class 150 FF (alternatives to special order)
Outlet connections	2½" BSP Male (alternatives to special order)
Monitor Body	Gunmetal LG2 to BS EN 1982
Bearings	316 Stainless Steel
Approx. weight (without nozzle/cannon)	33 kg

SALES & MARKETING

Angus Fire Ltd
Angus House, Haddenham Business Park,
Pegasus Way, Haddenham, Aylesbury, HP17 8LB, UK
Tel: +44 (0)1844 293600 • Fax: +44 (0)1844 293664

MANUFACTURING PLANT

Angus Fire Ltd
Station Road, Bentham, Lancaster, LA2 7NA, UK
Tel: +44 (0)1524 264000 • Fax: +44 (0)1524 264180

Angus Fire operates a continuous programme of product development. The right is therefore reserved to modify any specification without prior notice and Angus Fire should be contacted to ensure that the current issues of all technical data sheets are used.